



EASY PIECED TABLE RUNNER SERIES

—November—

12½" × 51½"



REQUIRED MATERIALS

- 8" × 8" **each** of two greens, two oranges, one rust, one brown
- 9" × 21" black with orange pumpkins
- 17" × 21" cream with orange pumpkins
- 14" × 14" cream
- 5" × 14" rust stripe
- 5" × 14" green
- ¾ yard brown plaid
- various colorful fabrics for appliqué
- 55" × 21" for backing

CUT FABRICS

From **each** of **two greens, two oranges, one rust, and one brown**, cut:

- (1) 7" × 7" square for **piecing**

From **black with orange pumpkins**, cut:

- (2) 7" × 7" squares for **piecing**

From **cream with orange pumpkins**, cut:

- (4) 7" × 7" squares for **piecing**

From **cream**, cut:

- (2) 6" × 12½" rectangles for **appliqué background**

From **green**, cut:

- (2) 1½" × 12½" strips for **outer sashing**

From **orange stripe**, cut:

- (2) 1½" × 12½" rectangles for **inner sashing**

From **brown plaid**, cut:

- (4) 2½" × WOF strips for **binding**

RECOMMENDED PRODUCTS

- Wafer 1 Lightbox
- Fusamat
- Olfa Spinning Rotary Mat 17" × 17"
- Creative Grids 2½" × 24½" Ruler
- Patchwork Pins
- Magnetic Pin Caddy
- Rotary Cutter

All available at ShabbyFabrics.com

As seen on our
**EASY PIECED TABLE RUNNER
SERIES - NOVEMBER**

video featured on our YouTube channel:



[YouTube.com/Shabby Fabrics](https://www.youtube.com/ShabbyFabrics)

KITS

featuring the fabrics seen in the video are available at

ShabbyFabrics.com

while supplies last!

PLEASE NOTE

WOF = Width of Fabric

RST = Right Sides Together

All seams are ¼" unless otherwise noted.

Please read all instructions carefully before beginning.

DISAPPEARING 4-PATCH

FOR THIS BLOCK, PRESS ALL SEAMS OPEN.

STEP 1: Sew (2) cream with orange pumpkins squares, (1) rust square, and (1) green square into a 4-Patch as shown. **STEP 2:** Measure and cut 2" from center seams, rotating block 90° after each cut. **STEP 3:** Move corner units (outlined in red) one position clockwise.

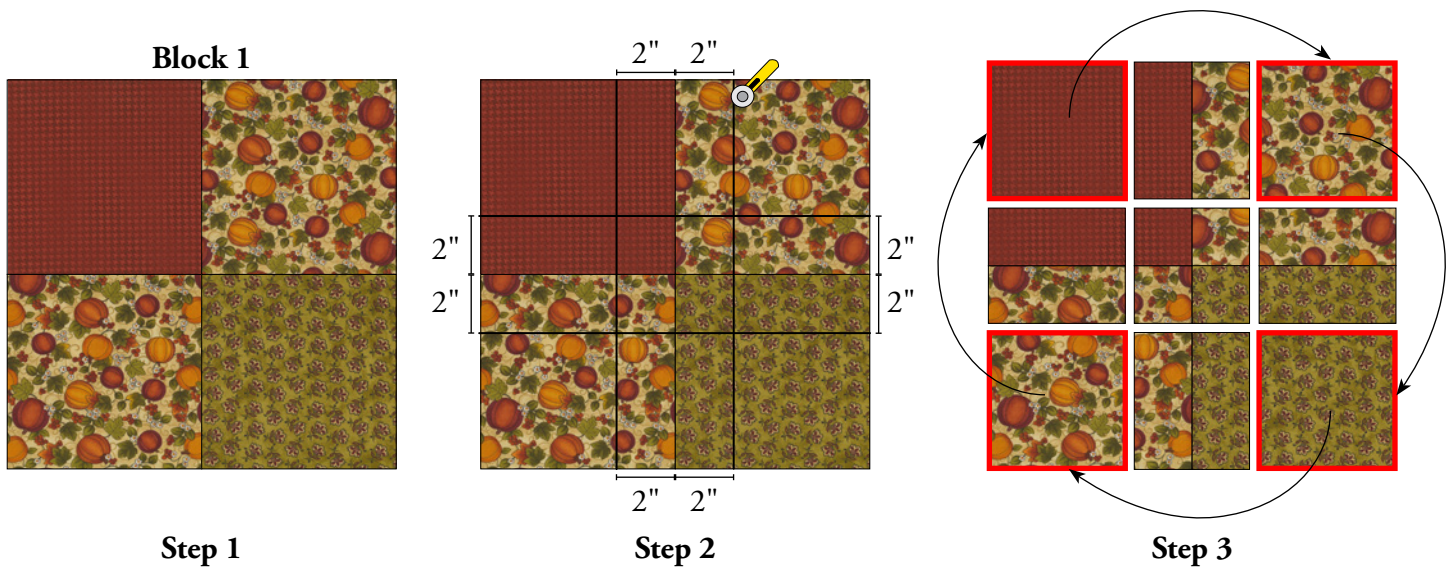

STEP 4: Refer to this image to verify that all units are arranged properly. **STEP 5:** Sew units together into rows. **STEP 6:** Sew rows together to complete block. Block will measure 12½" × 12½".

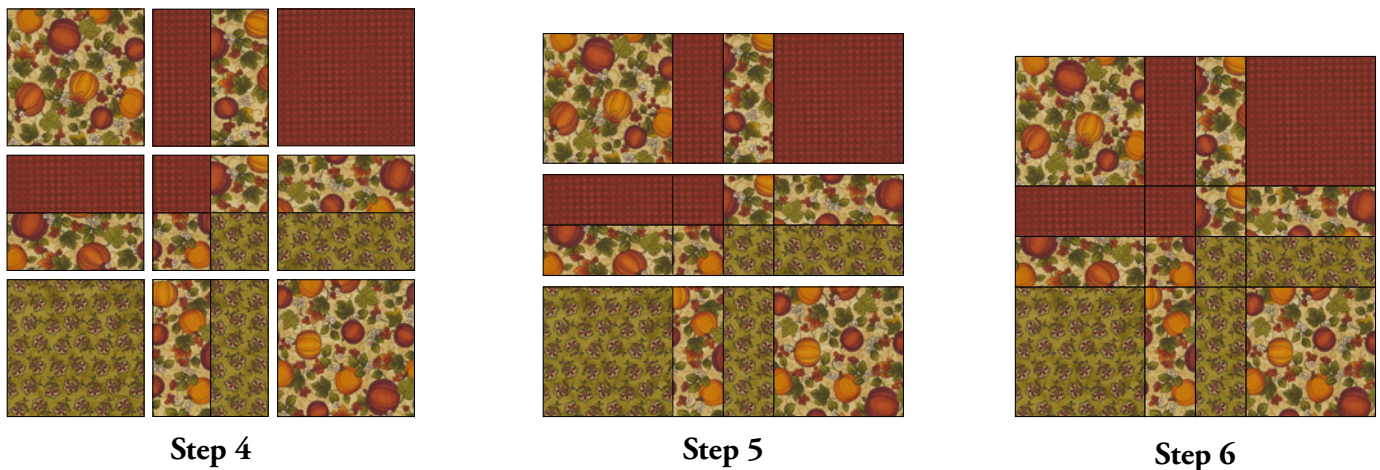

Repeat to make a total of (3) Disappearing 4-Patch Blocks, (1) that is cream, green, and rust (*Block 1, above*), (1) that is black, orange, and orange (*Block 2, at right*) and (1) that is cream, green, and brown (*Block 3, far right*). Set blocks aside for assembly at a later step.

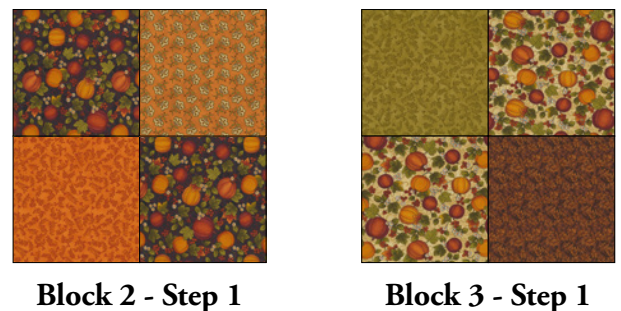

APPLIQUÉ

Sew (1) rust stripe **inner sashing** strip to a cream **background**; press toward inner sashing. Sew (1) green **outer sashing** strip to the other side; press toward outer sashing. Repeat with second background.



Your diagram has two pages, a **Reverse Diagram** and an **Assembly Diagram**. When tracing shapes for fusible appliqué, use the Reverse Diagram.

Gently peel fusible paper from the back of each shape. Refer to **Assembly Diagram** to arrange shapes on background fabric.

Appliqué in place using the method and stitch of your choice.



ASSEMBLE TABLE RUNNER

Sew blocks together in a row, pressing seams open. Sew one appliqué unit to each side as shown.

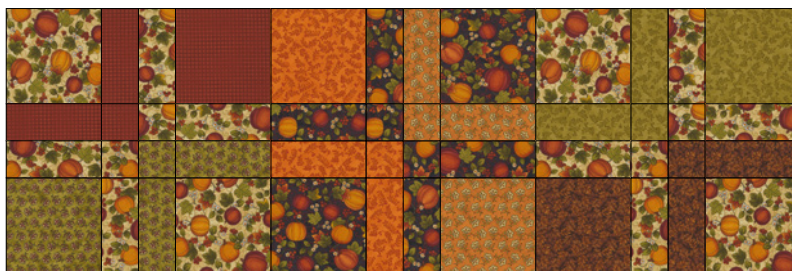

FINISH TABLE RUNNER

Layer top, batting, and backing. Quilt as desired.

Piece binding into one long strip. Fold in half lengthwise, wrong sides together, and press. Line up raw edges of the binding with the raw edge of the table runner. Sew binding to the front side of the table runner, starting at any side. Turn the binding over and hand stitch to the back of the table runner.

Shop 24/7 for BOMs and Clubs, kits, and *more* at ShabbyFabrics.com!



EASY PIECED

TABLE RUNNER SERIES

—November—

ShabbyFabrics.com

© 2019 Shabby Fabrics

Reverse Diagram

Use this diagram for fusible appliqué

Numbers indicate the order in which shapes are to be placed.
Dashed lines indicate where one shape lies behind another.

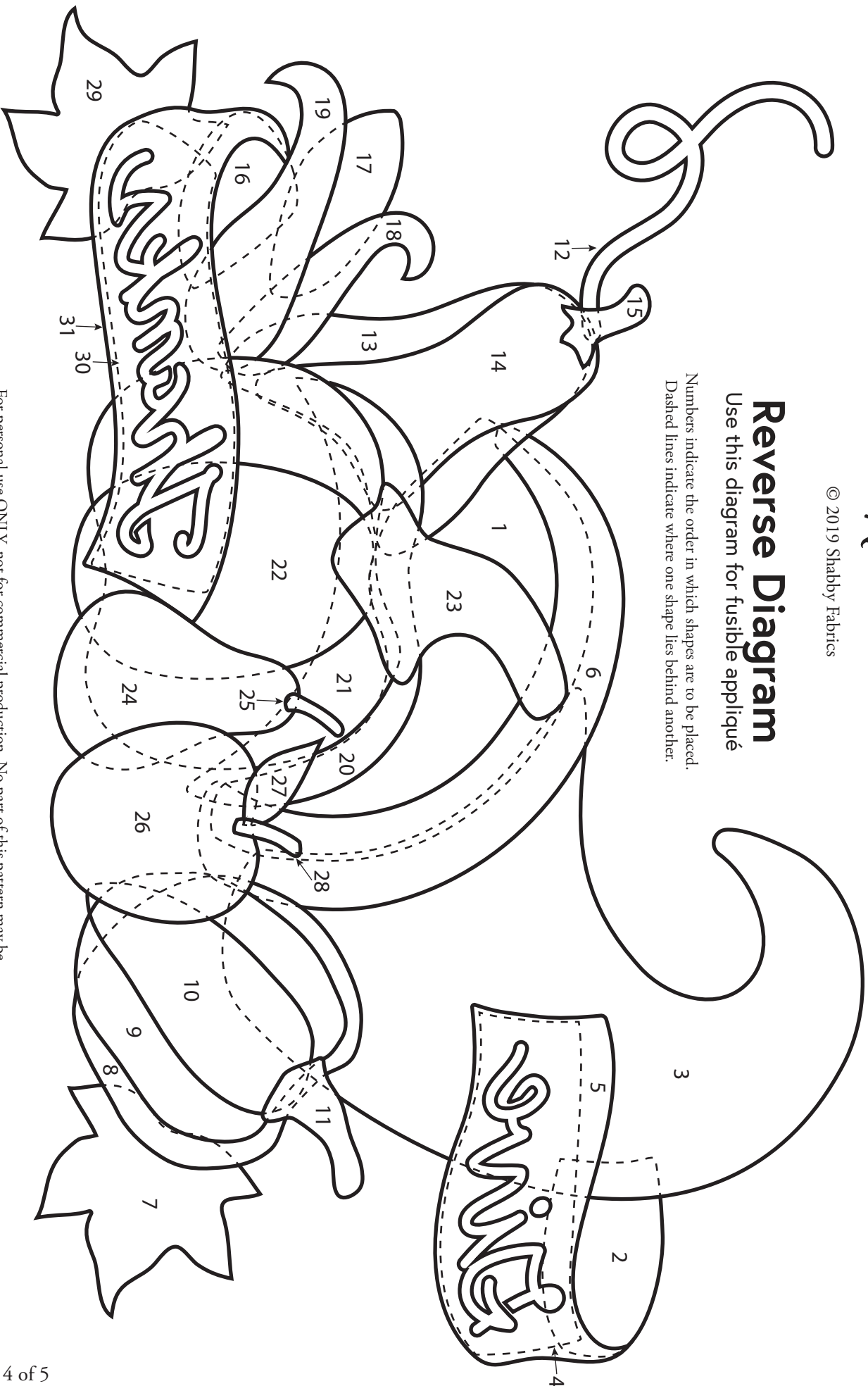

For personal use ONLY, not for commercial production. No part of this pattern may be digitized or reproduced in any form unless given express written consent by Shabby Fabrics. All designs are protected by federal copyright law. All rights reserved.



Assembly Diagram

Use this diagram for placement

Numbers indicate the order in which shapes are to be placed.
Dashed lines indicate where one shape lies behind another.

