



# EASY PIECED

## TABLE RUNNER SERIES

July 12½" × 51½"



### REQUIRED MATERIALS

- ½ yard cream starbursts
- ¼ yard blue texture
- 9" × 21" (Fat Eighth) red texture
- 7" × WOF sky blue
- 5" × 14" green
- 15" × WOF red stripe
- various colorful fabrics for appliqué
- 55" × 21" for backing

### CUT FABRICS

From **cream starbursts**, cut:

- (6) 8" × 8" squares for **piecing**
- (3) 1" × 6" rectangles for **dimensional quilts** (optional)
- (2) 2" × 2" squares for **dimensional backing** (optional)

**NOTE:** Dimensional quilts are optional. If you prefer to appliqué the quilt, be sure to trace and cut those shapes.

From **blue texture**, cut:

- (4) 8" × 8" squares for **piecing**
- (3) 1" × 6" rectangles for **dimensional quilts** (optional)

From **red texture**, cut:

- (2) 8" × 8" squares for **piecing**

From **sky blue**, cut:

- (2) 6" × 12½" rectangles for **appliqué background**

From **green**, cut:

- (2) 1½" × 12½" rectangles for **outer sashing**

From **red stripe**, cut:

- (4) 2½" × WOF strips for **binding**
- (2) 1½" × 12½" strips for **inner sashing**

### RECOMMENDED PRODUCTS

- Wafer 1 Lightbox
- Appliqué Pressing Sheet
- Olfa Spinning Rotary Mat 17" × 17"
- Creative Grids 6½" × 12½" Ruler
- Creative Grids 8½" × 8½" Ruler
- Patchwork Pins
- Magnetic Pin Caddy
- Rotary Cutter
- Quarter Inch Seam Markers
- Point 2 Point Turner

All available at [ShabbyFabrics.com](http://ShabbyFabrics.com)

As seen on our  
**EASY PIECED TABLE  
RUNNER SERIES - JULY**  
video featured on our YouTube channel:



[YouTube.com/Shabby Fabrics](https://www.youtube.com/ShabbyFabrics)

### PLEASE NOTE

WOF = Width of Fabric

RST = Right Sides Together

All seams are ¼" unless otherwise noted.

Please read all instructions carefully before beginning.

## DISAPPEARING HOURLGLASSES

**STEP 1:** On the back of (1) cream 8" x 8" square, draw a line diagonally from corner to corner. **STEP 2:** Layer cream square on (1) blue texture 8" x 8" square, right sides together, being sure to line up the edges. **STEP 3:** Sew  $\frac{1}{4}$ " on both sides of the drawn line. **STEP 4:** Cut on the drawn line. Press toward dark fabric. **STEP 5:** You will now have (2) Half Square Triangles. Trim each half-square triangle to measure 7" x 7". **STEP 6:** Repeat Steps 1-5 to make another set of (2) Half Square Triangles, for a total of (4) Half Square Triangles.

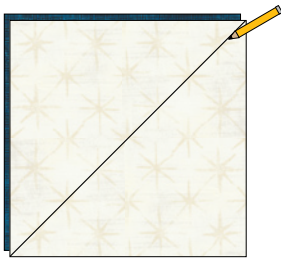

Steps 1-2

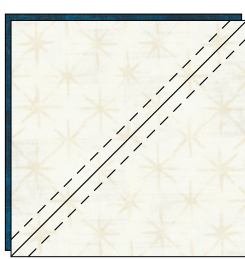

Step 3

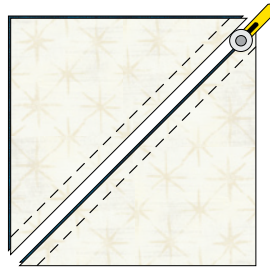

Step 4

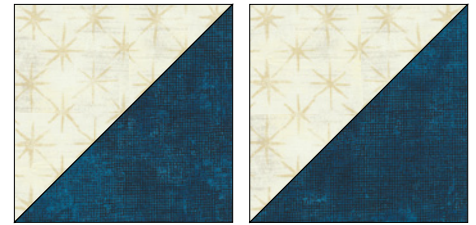

Step 5

**STEP 7:** Arrange the (4) Half Square Triangles as shown. Sew together to create an Hourglass Block, pressing seams toward dark fabric. Block should measure  $13\frac{1}{2}$ " x  $13\frac{1}{2}$ ". **STEP 8:** Cut Hourglass Block into (9)  $4\frac{1}{2}$ " x  $4\frac{1}{2}$ " squares. **STEP 9:** Rotate blocks as shown. (All outer blocks are rotated 180°. Center block is rotated 90°.) **STEP 10:** Sew squares back together, pressing seams as desired. Block will now measure  $12\frac{1}{2}$ " x  $12\frac{1}{2}$ ".

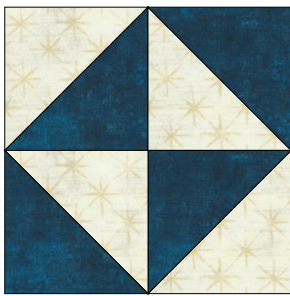

Steps 6-7

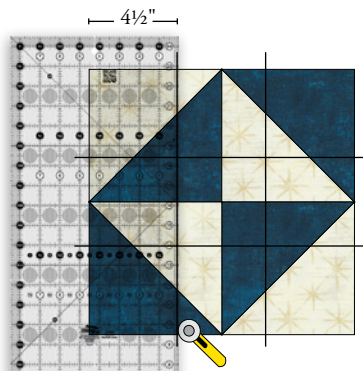

Step 8

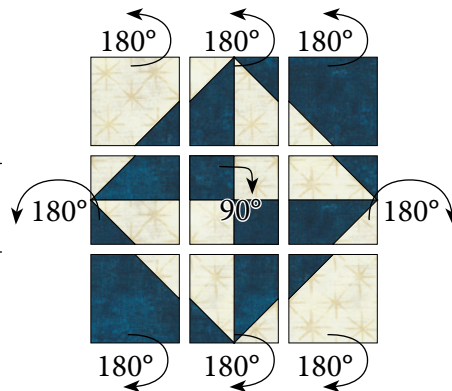

Step 9

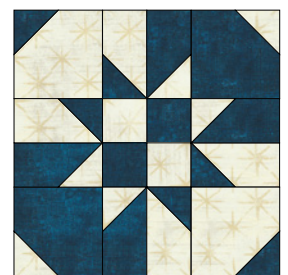

Step 10

Repeat to make a total of (3) Disappearing Hourglass Blocks, (2) with cream and blue, and (1) with cream and red. Set blocks aside for assembly at a later step.

## APPLIQUÉ

Sew (1) **inner sashing** strip to a blue sky **background**; press toward inner sashing. Sew (1) green **outer sashing** strip to the other side; press toward outer sashing. Repeat with second background.

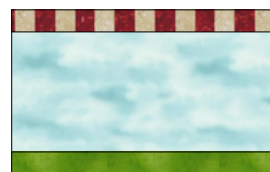
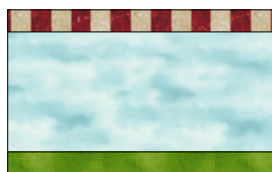

Your diagram has two pages, a **Reverse Diagram** and an **Assembly Diagram**. When tracing shapes for fusible appliqué, use the Reverse Diagram.

Gently peel fusible paper from the back of each shape. Refer to **Assembly Diagram** to arrange shapes on background fabric. Appliqué in place using the method and stitch of your choice.

## DIMENSIONAL QUILT (OPTIONAL)

*If you do not wish to create the dimensional quilt, you may opt to appliqué the quilt design on the barn instead.*

**STEP 1:** Sew (1) blue 1" x 6" rectangle to the top of (1) cream 1" x 6" rectangle, and (1) blue 1" x 6" rectangle to the bottom, pressing seams toward blue. **STEP 2:** Cut strip set into 1" sections to make (4) blue/cream/blue units. **STEP 3:** Sew (1) cream 1" x 6" rectangle to the top of (1) blue 1" x 6" rectangle, and (1) cream 1" x 6" rectangle to the bottom, pressing seams toward blue. **STEP 4:** Cut strip set into 1" sections to make (2) cream/blue/cream units.

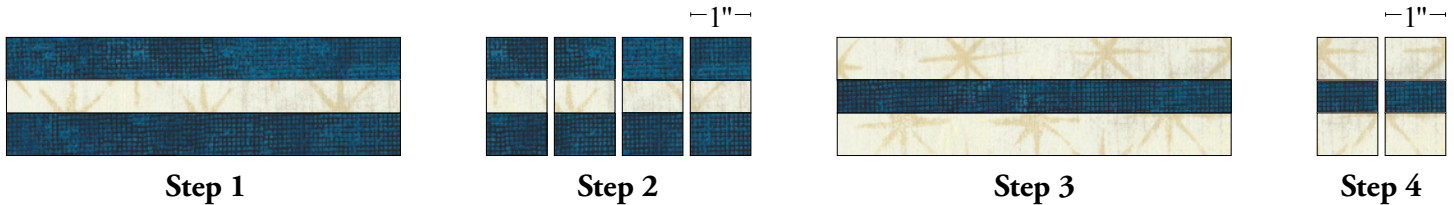

**STEP 5:** Sew (1) blue/cream/blue unit to the left side of a cream/blue/cream unit, and (1) blue/cream/blue unit to the right side, pressing seams as desired. Quilt top should measure 2" x 2". **STEP 6:** Place (1) cream 2" x 2" square, RST, on top of (1) quilt top. **STEP 7:** Sew around all four sides, and clip corners. **STEP 8:** Make a slit in the quilt backing, and turn quilt right side out. **STEP 9:** Push corners out and press. Stitch in the ditch between every seam to "quilt." **STEP 10:** Repeat Steps 5-9 to make a second quilt. *You will attach the dimensional quilts to the barns after the table runner is quilted.*

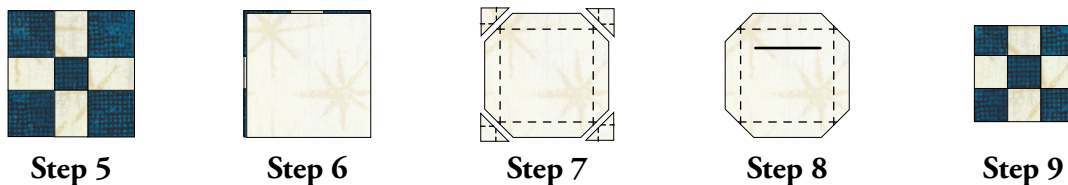

## ASSEMBLE TABLE RUNNER

Sew blocks together in a row, pressing seams open. Sew one appliqué unit to each side as shown.

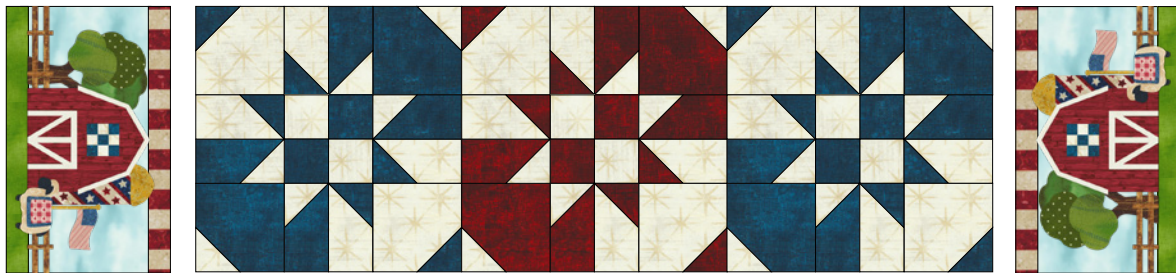

## FINISH TABLE RUNNER

Layer top, batting, and backing. Quilt as desired.

Piece binding into one long strip. (We used a straight seam so we could match up the stripes.) Fold in half lengthwise, wrong sides together, and press. Line up raw edges of the binding with the raw edge of the table runner. Sew binding to the front side of the table runner, starting at any side. Turn the binding over and hand stitch to the back of the table runner.

*If you've opted to create the dimensional quilt:* Refer to Assembly Diagram for placement. Secure quilt in place by sewing along the top side of the quilt (or if you prefer, secure around all four sides) with the stitch of your choice.





# EASY PIECED

## TABLE RUNNER SERIES

— July —

## Reverse Diagram

Use this diagram for fusible appliqué

Numbers indicate the order in which shapes are to be placed. Dashed lines indicate where one shape lies behind another.

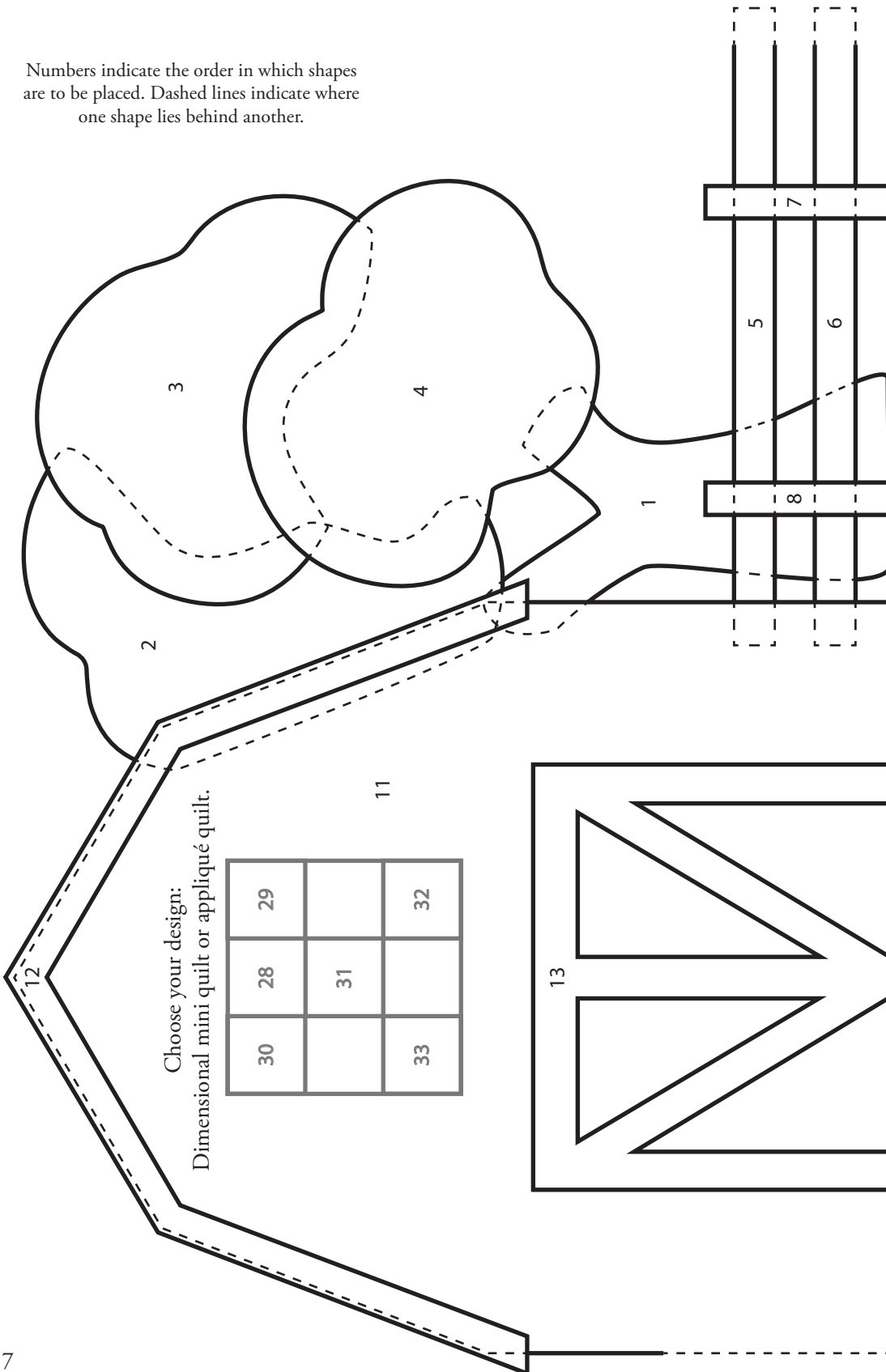

For personal use ONLY, not for commercial production. No part of this pattern may be digitized or reproduced in any form unless given express written consent by Shabby Fabrics. All designs are protected by federal copyright law. All rights reserved.

ShabbyFabrics.com

© 2019 Shabby Fabrics



# EASY PIECED

TABLE RUNNER SERIES

— July —

## Reverse Diagram

Use this diagram for fusible appliqué

Numbers indicate the order in which shapes are to be placed. Dashed lines indicate where one shape lies behind another.

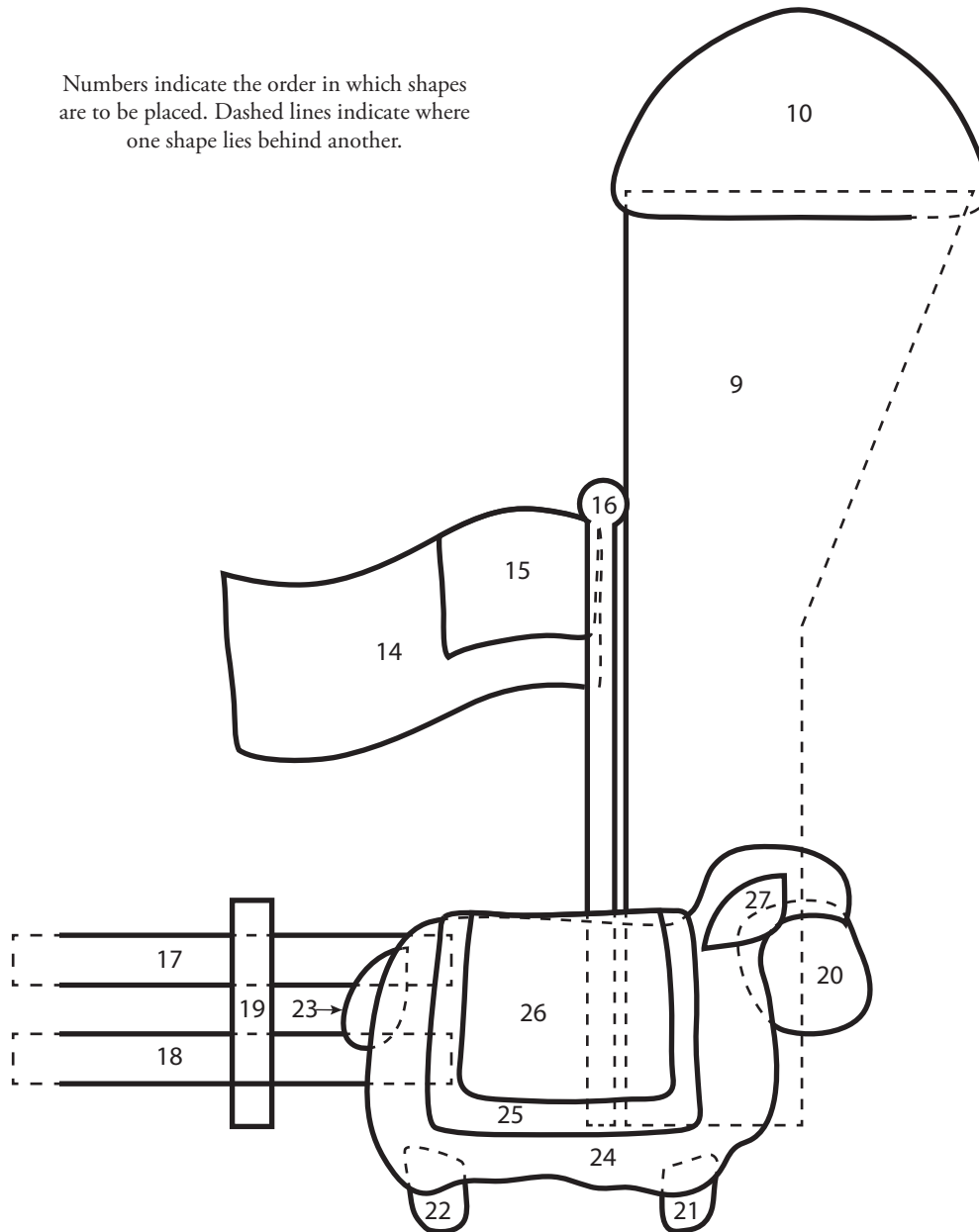

ShabbyFabrics.com

© 2019 Shabby Fabrics



## Assembly Diagram

Align pages using dashed line as a guide,  
and secure with tape.

page 6 of 7



# EASY PIECED

## TABLE RUNNER SERIES

—July—

## Assembly Diagram

Use this diagram for placement

Numbers indicate the order in which shapes are to be placed. Dashed lines indicate where one shape lies behind another.

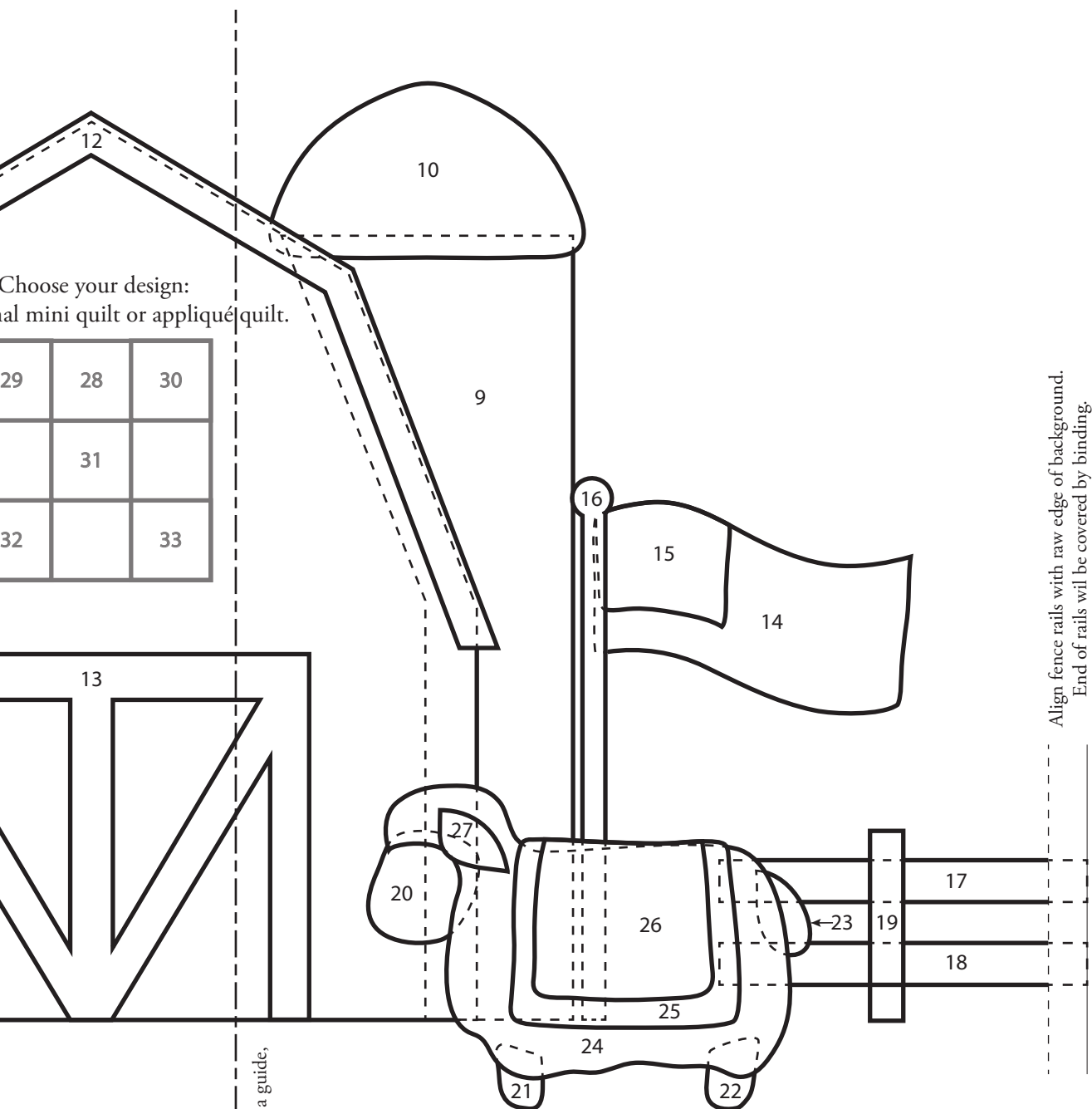

ShabbyFabrics.com

© 2019 Shabby Fabrics

For personal use ONLY, not for commercial production. No part of this pattern may be digitized or reproduced in any form unless given express written consent by Shabby Fabrics. All designs are protected by federal copyright law. All rights reserved.