

# PIECED LEAF BLOCK

## NOTE

All seam allowances are  $\frac{1}{4}$ " RST = Right Sides Together  
HST = Half Square Triangle

## CUT FABRICS

From **tan**, cut:

- (1)  $1\frac{1}{2}$ "  $\times$   $1\frac{1}{2}$ " square
- (3)  $1\frac{7}{8}$ "  $\times$   $1\frac{7}{8}$ " squares

From **gold**, cut:

- (3)  $1\frac{7}{8}$ "  $\times$   $1\frac{7}{8}$ " squares

From **yellow**, cut:

- (1)  $3\frac{1}{2}$ "  $\times$   $3\frac{1}{2}$ " square

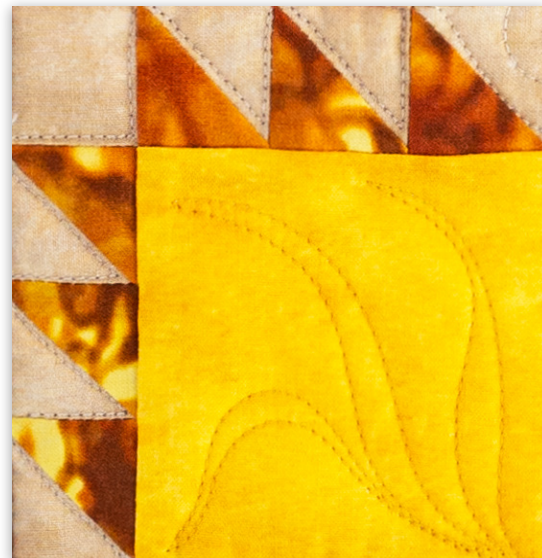

## LEAF BLOCK

**STEP 1:** On the back of (1) tan  $1\frac{7}{8}$ "  $\times$   $1\frac{7}{8}$ " square, draw a line diagonally from corner to corner. **STEP 2:** Layer tan  $1\frac{7}{8}$ "  $\times$   $1\frac{7}{8}$ " square on top of gold square, RST, making sure to line up the edges.

**STEP 3:** Shorten your stitch length and sew  $\frac{1}{4}$ " on both sides of the drawn line. **STEP 4:** Cut on the drawn line. Press toward color.

**STEP 5:** You will now have two HSTs, which should each measure  $1\frac{1}{2}$ "  $\times$   $1\frac{1}{2}$ " square.

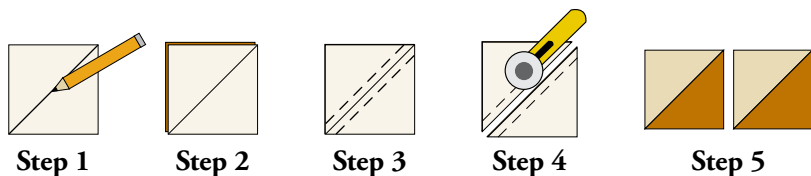

**STEP 6:** Using (2) additional  $1\frac{7}{8}$ "  $\times$   $1\frac{7}{8}$ " tan squares, and the (2) remaining gold squares, repeat Steps 1-5 to make four more HST. You will now have six HST. Join them into two rows of three, orienting diagonals as shown, pressing seams open.

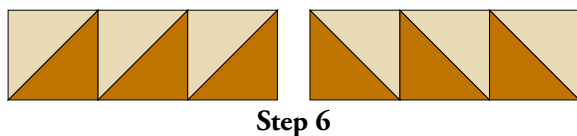

**STEP 7:** Sew (1) tan  $1\frac{1}{2}$ "  $\times$   $1\frac{1}{2}$ " square to the right end of the top row as shown, pressing toward tan square.

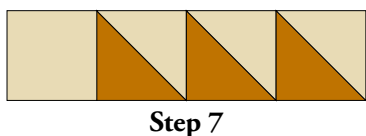

**STEP 8:** Join row of three HST to the right side of yellow square, pressing toward colored square.

**STEP 9:** Join top row to complete the block, pressing toward colored square.

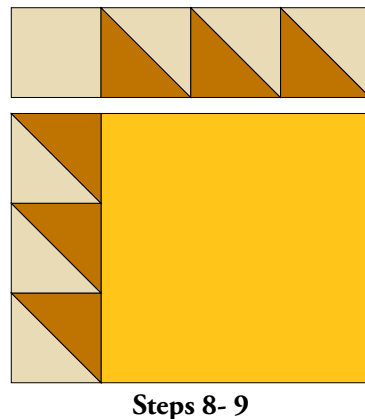

Leaf Block will measure  $4\frac{1}{2}$ "  $\times$   $4\frac{1}{2}$ ".