

# PIECED TREE & PIECED GIFT BLOCK

## NOTE

All seam allowances are  $\frac{1}{4}$ " RST = Right Sides Together

## CUT FABRICS

From **cream**, cut:

- (1) 6"  $\times$  9" rectangle for **Tree Block** (label "A")
- (1) 2"  $\times$  3½" rectangle for **Gift Block** (label "F")
- (2) 2"  $\times$  2¼" rectangles for **Tree Block** (label "C")
- (2) 2"  $\times$  1" rectangles for **Gift Block** (label "E")

From **green**, cut:

- (1) 5½"  $\times$  8½" rectangle for **Tree Block** (label "B")

From **brown**, cut:

- (1) 1½"  $\times$  2¼" rectangle for **Tree Block** (label "D")

From **red**, cut:

- (2) 2"  $\times$  3" rectangles for **Gift Block** (label "H")

From **gold**, cut:

- (2) 2"  $\times$  2" squares for **Gift Block** (label "G")
- (1) 1½"  $\times$  3" rectangle for **Gift Block** (label "I")

Follow along with the  
HOW TO MAKE A  
PIECED TREE AND  
PIECED GIFT BLOCK  
video featured on our YouTube channel:



[YouTube.com/Shabby Fabrics](https://www.youtube.com/ShabbyFabrics)

## TREE BLOCK

Refer to Tree Block Assembly (*right, and top of page 2*).

**STEP 1:** Fold cream (A) rectangle in half lengthwise and finger press to find the center. Unfold and mark the top center point on the right side of the fabric with a dot. Draw a line from the top center point to the bottom left corner, and to the bottom right corner.

**STEP 2:** Cut along the drawn lines. You will only use the two outer pieces. (Save or discard the center piece as you prefer.)

**STEP 3:** Using the same technique as in Step 1, on the right side of green (B) rectangle, find and mark the top center point. Draw a line from the center point to the bottom left corner, and to the bottom right corner.

**STEP 4:** Cut along the drawn lines. You will only use the center piece. (Save or discard the outer pieces as you prefer.)

*Continued on next page...*



*A Year in Words*  
WALL HANGINGS

**KITS**

available at  
[ShabbyFabrics.com](https://www.shabbyfabrics.com)  
*while supplies last!*

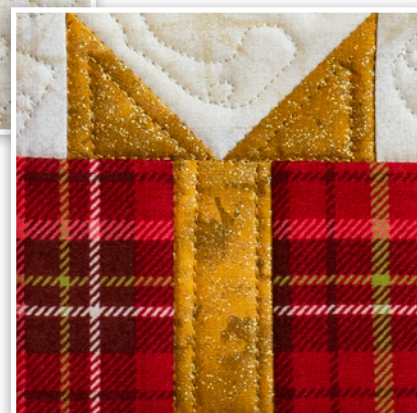

### Tree Block Assembly

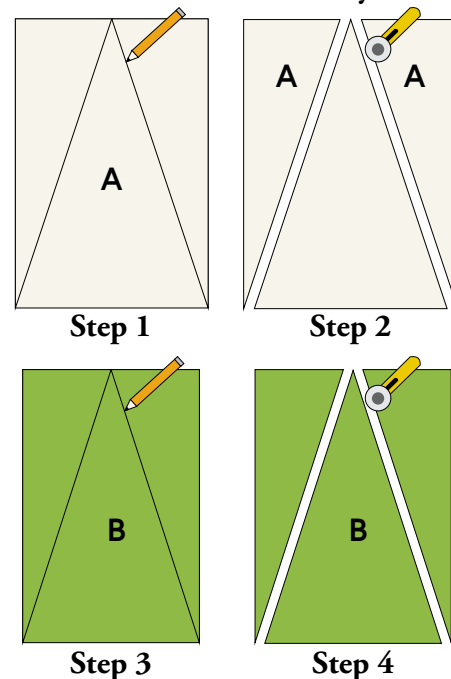

**STEP 5:** Place the green (B) center triangle right side up. Place (1) cream “A” outer piece on top of the green tree triangle, RST, aligning top corners. The outer “A” pieces will extend below bottom edge of green (B) triangle. Stitch along the long side, pressing seam away from the center (B) triangle.

**STEP 6:** Repeat for left side of tree.

**STEP 7:** Trim to  $4\frac{1}{2}'' \times 6\frac{3}{4}''$ , making sure that a  $\frac{1}{4}''$  seam allowance remains at top of tree, and that point of tree remains centered. This is your tree unit.

**STEP 8:** With RST, stitch a cream (C) rectangle to either side of brown (D) rectangle. Press seams to the outside. This is your trunk unit.

**STEP 9:** Attach tree unit to trunk unit, pressing seams as desired.

Tree Block will measure  $4\frac{1}{2}'' \times 8\frac{1}{2}''$ .

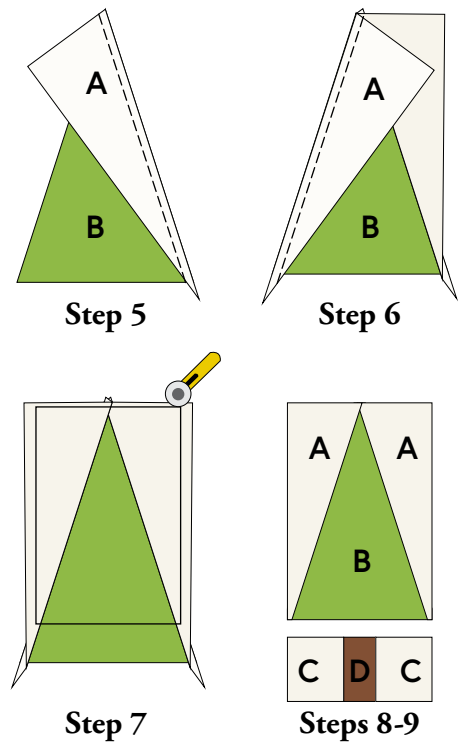

## GIFT BLOCK

Refer to Gift Block Assembly (*right*).

**STEP 1:** On the back of a gold (G) square, draw a line diagonally from corner to corner. Place square in the left corner of cream (F) rectangle, noting orientation of the diagonal.

**STEP 2:** Sew on the drawn line, and trim seam allowance to  $\frac{1}{4}''$ . Press to the outside.

**STEP 3:** On the back of a gold (G) square, draw a line diagonally from corner to corner. Place square in the right corner of the cream rectangle, noting orientation of the diagonal.

**STEP 4:** Sew on the drawn line, and trim seam allowance to  $\frac{1}{4}''$ . Press to the outside.

**STEP 5:** Sew (1) cream texture (E) rectangle to each end of this unit, pressing seams outward. This is your bow unit.

**STEP 6:** Sew (1) red plaid (H) rectangle to each side of gold (I) rectangle, pressing seams inward. This is your box unit.

**STEP 7:** Join bow unit to box unit, pressing seam toward box unit.

Gift Block will measure  $4\frac{1}{2}'' \times 4\frac{1}{2}''$ .

### Gift Block Assembly

