

QUILLOW

in **STOMP STOMP ROAR!**
by *moda*

Quilt finishes to 40" × 71½"
Folds inside quillow to approx. 17½" × 17½"

PLEASE NOTE

Pay close attention to seam allowances: some are ½", some are ¼".

REQUIRED MATERIALS

- (4) Charm Packs **OR** (1) Layer Cake, cut to 5" squares **OR** (153) assorted 5" × 5" squares
- ⅝ yard teal for pillow borders and pillow backing
- 2⅛ yard blue with dinosaurs for quilt backing
- (1) 42" × 74" for batting for quilt
- (1) 20" × 20" for batting for pillow

CUT FABRICS

From **charm packs**, select:

- (144) 5" × 5" squares for **patchwork quilt front**
- (9) 5" × 5" squares for **9-patch pillow front**

From **teal solid**, cut:

- (1) 20" × 20" square for **pillow backing**
- (2) 2¾" × 18½" rectangles for **pillow top/bottom borders**
- (2) 2¾" × 14" rectangles for **pillow side borders**

From **batting**, cut (at least):

- (1) 42" × 74" for **quilt batting**
- (1) 20" × 20" for **pillow batting**

PATCHWORK PILLOW FRONT

Arrange squares as desired in (3) rows of (3) squares each.

Sew squares into rows using a ¼" seam allowance. Press rows in alternating directions, as indicated by arrows.

Sew rows together using a ¼" seam allowance. Press seams up or down as desired.

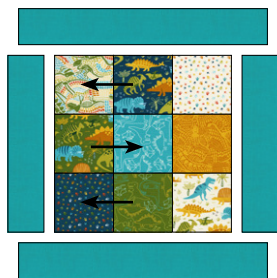

Pillow Assembly



KITS available at ShabbyFabrics.com
while supplies last!

Follow along with Jen on our
**HOW TO MAKE A
QUILLOW**
video featured on our YouTube channel:



[YouTube.com/ShabbyFabrics](https://www.youtube.com/ShabbyFabrics)

Using a ¼" seam allowance, sew **pillow side border** to left and right side of pillow front. Press toward border. Sew pillow **top/bottom border** to top and bottom of pillow front. Press toward border.

Layer **pillow batting**, **pillow backing** (right side up), and pillow front (wrong side up), with pillow front centered. Pin layers together.

Using a **½" seam allowance**, sew around all four sides of pillow front, leaving a 4"-5" opening on one side for turning.

Trim batting and backing to be even with the patchwork pillow front. Clip corners. Remove pins. Turn right side out, pushing out corners. Fold and press seam allowance at opening, then sew opening closed. Top stitch ¼" around all four sides.

Pillow top should measure 17½" × 17½".

Quilt as desired. Set aside.

PATCHWORK QUILT FRONT-----

Refer to Quilt Assembly diagram (*right*). Arrange squares as desired in (16) rows of (9) squares each.

Sew squares into rows using a ¼" seam allowance. Press rows in alternating directions, as indicated by arrows.

Sew rows together using a ¼" seam allowance. Press seams up or down as desired.

Stay stitch ¼" from raw edge on all four sides.

Layer **quilt batting**, **quilt backing** (right side up), and patchwork quilt front (right side down), with quilt front centered. Pin layers together.

Using a ½" **seam allowance**, sew around all four sides of quilt front, leaving an 8"-10" opening on one side for turning.

Trim batting and backing to be even with the patchwork quilt front. Clip corners. Remove pins. Turn right side out, pushing out corners. Fold and press seam allowance at opening, then sew opening closed.

Quilt top should measure 40" × 71½". Quilt as desired.

ASSEMBLE QUILLOW-----

Refer to Quillow Assembly diagram (*below*). Place quilt on work surface, backing side up. Place pillow front on quilt, backing side up, centered with bottom edges aligned. Pin in place.

Using a generous ¼" seam allowance, stitch around sides and bottom of pillow top, backstitching to secure at the top edges. Because this seam will have repeated stress when the quilt is folded into the pillow, we recommend sewing this seam a second time.



Quillow Assembly

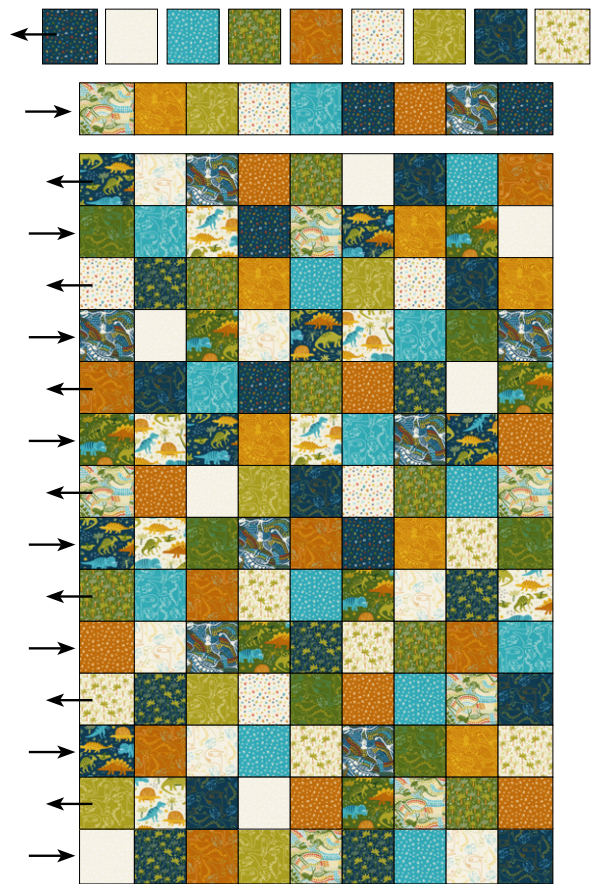

Quilt Assembly

FOLDING THE QUILLOW-----

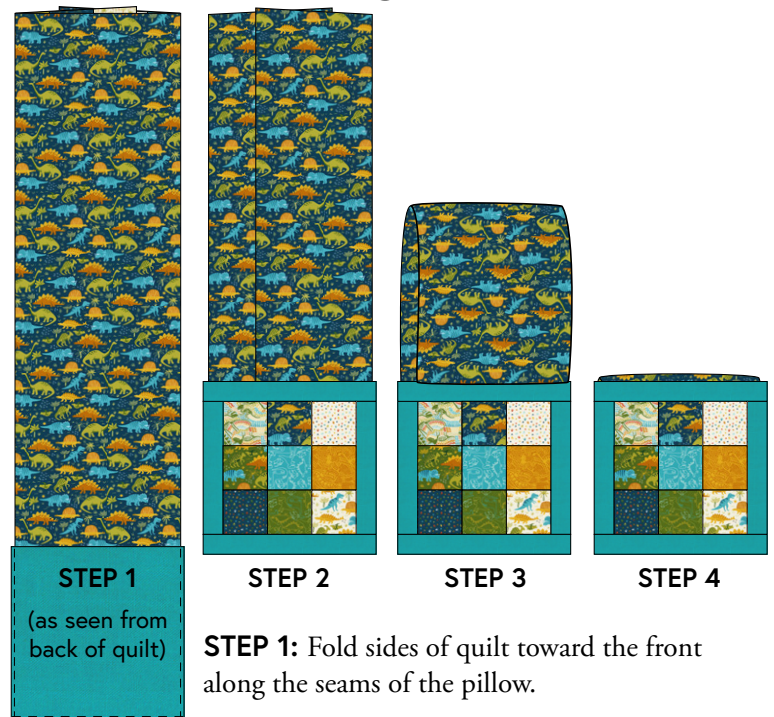

STEP 1: Fold sides of quilt toward the front along the seams of the pillow.

STEP 2: Turn pillow right side out over quilt, as if you were folding the cuff on a pair of socks.

STEP 3: Fold the top of the quilt down to meet the top of the pillow.

STEP 4: Tuck the folded quilt inside the pillow.